

# Stitches & Sew Forth



Love Is Spoken Here – SF 117

## "Love Is Spoken Here"

I would like to dedicate this pattern  
to all of my family. My husband Kelly, my kids,  
Taelor, Mason, Mikayla, Challis, and Hunter.  
Thank you for being mine, I love you all.

Each row created should measure 45" wide.  
All seams are a standard 1/4".

### #1 Houses

#### *Cutting Instructions:*

Background Fabric (instructions are for both  
houses): cut four  $2\frac{1}{2}$ "  $\times$   $10\frac{1}{2}$ ", four  $2\frac{1}{2}$ "  $\times$   $13\frac{1}{4}$ ", and  
four  $3\frac{1}{2}$ "  $\times$   $3\frac{1}{2}$ " squares.

Doors: from two different prints cut  $2\frac{1}{2}$ "  $\times$  6"

Windows: cut four 2"  $\times$  2"

Roof: cut two different prints  $3\frac{1}{2}$ "  $\times$   $6\frac{1}{2}$ "

House: cut two different prints, two  $2\frac{1}{2}$ "  $\times$  6", two  
2"  $\times$   $6\frac{1}{2}$ ", three  $1\frac{1}{2}$ "  $\times$  2"

#### *Sewing Instructions:*

Draw diagonal lines on the back of  $3\frac{1}{2}$ " background  
squares. Place one square on the end of roof fabric  
with right sides together. Sew on the diagonal line.  
Cut 1/4" from stitching line and press. Repeat with  
other square. Sew door between  $2\frac{1}{2}$ "  $\times$  6" house  
fabric. Press. Sew 2"  $\times$   $6\frac{1}{2}$ " house fabric on top of  
door/house section. Sew 2" windows between  
 $1\frac{1}{2}$ "  $\times$  2" house print. Press. Sew this onto top of  
house section. Press. Sew 2"  $\times$   $6\frac{1}{2}$ " house print onto

top of this section. Sew roof unit on top. Press.  
Repeat for the other house. Sew background  
 $2\frac{1}{2}$ "  $\times$   $13\frac{1}{2}$ " borders onto house sides, then  
 $2\frac{1}{2}$ "  $\times$   $10\frac{1}{2}$ " onto top and bottom.

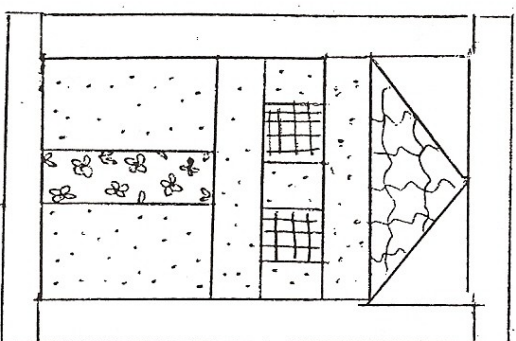

### #2 Stars

#### *Cutting Instructions:*

Background fabrics, from three different fabrics  
cut: four  $2\frac{1}{2}$ "  $\times$   $2\frac{1}{2}$ ", one 6"  $\times$  6"

Star centers: from three different prints cut one  
 $4\frac{1}{2}$ "  $\times$   $4\frac{1}{2}$ " square.

Star points: from three different prints cut one  
6"  $\times$  6" square.

#### *Sewing Instructions:*

On the wrong side of the 6" background squares  
draw two diagonal lines from corner to corner. Place  
right sides together with one 6" star point fabric.



Sew  $1/4$ " on each side of diagonal line. (Refer to diagram.) Cut block apart by cutting on the drawn lines (do not move fabrics) and cut 3" over vertically and horizontally. This gives you eight half square triangles. Leaving triangles closed, square up with the "Quilt in a Day" triangle square up ruler, on the  $2\frac{1}{2}$ " line. Press open. Assemble star as in diagram and repeat with remaining fabrics. Sew the three stars together. Press.

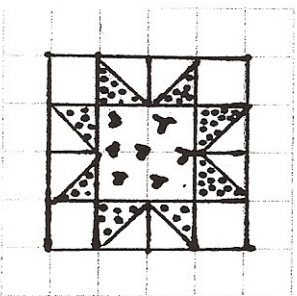
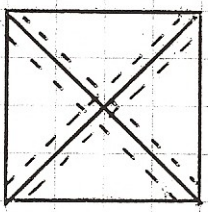

### #3 Stitchery (Love is spoken here)

#### *Cutting Instructions:*

Cut stitching fabric a little larger than needed. After stitching is complete trim to measure

$6\frac{3}{4}$ " x 22".

Border: cut two  $1\frac{3}{4}$ " x 22" strips for top and bottom, cut two  $1\frac{3}{4}$ " x  $9\frac{1}{4}$ " for sides.

#### *Sewing Instructions:*

Trace words and vines onto fabric, stitch using three strands of DMC floss. Backstitch words with 310 black, vines with 730 green, satin stitch large heart and french knot berries with 814 maroon.

\*note: small hearts can be stitched or buttons may be used.

Cut finished stitchery and border.



### #4 Hearts

#### *Cutting Instructions:*

Background fabric - cut three 8" x 8" squares, two  $4\frac{3}{4}$ " x 9", two  $1\frac{3}{4}$ " x  $4\frac{3}{4}$ ", six  $3\frac{1}{2}$ " x  $3\frac{1}{2}$ ", one  $3\frac{1}{4}$ " x  $6\frac{1}{4}$ " rectangle.

Heart fabrics: from three different prints, cut one 8" x 8", one  $3\frac{1}{2}$ " x  $6\frac{1}{2}$ ", and one  $3\frac{1}{2}$ " x  $12\frac{1}{2}$ ". Leaf print cut one  $3\frac{1}{4}$ " x  $6\frac{1}{4}$ " rectangle.

#### *Sewing Instructions:*

Using one 8" background square and one 8" print, place right sides together and draw diagonal lines from corner to corner, on wrong side of background fabric. Sew  $1/4$ " on both sides of drawn line. Cut block apart by cutting on the drawn line (do not move fabrics) and cut 4" over horizontally and vertically. This gives you eight half square triangles. Leave triangles closed, square up using "Quilt in a Day" triangle square up ruler on the  $3\frac{1}{2}$ " line. Repeat with remaining 8" squares. Assemble heart as in diagram.

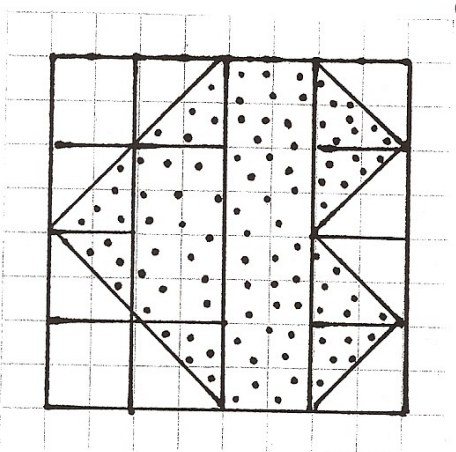

To create leaves, use  $3\frac{1}{4}" \times 6\frac{1}{4}"$  background and leaf print. On the wrong side of background fabric, draw a line half way ( $3\frac{1}{8}"$ ) through. Mark from bottom of center to top corner creating a "V". Place right sides together with leaf fabric, sew  $\frac{1}{4}"$  on each side of line as in diagram.

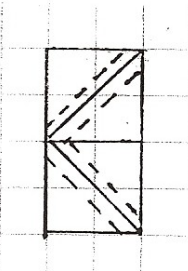

Cut apart on the "V" line as well as drawn line.

Square up with "Quilt in a Day" triangle square up ruler using the  $2\frac{5}{8}"$  line. Press open. Sew triangles together as in diagram. Sew  $4\frac{3}{4}" \times 9"$  on top of leaves and  $1\frac{3}{4}" \times 4\frac{3}{4}"$  on bottom of leaves. Press. Sew together in this order: heart, leaf section, heart, leaf section, heart. Press.

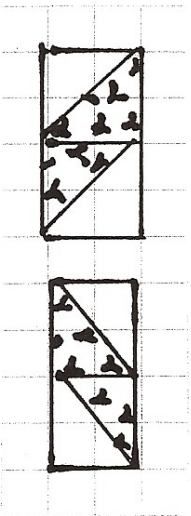

### #5 Log Cabins

Red in the center of a log cabin block represents the heart of the home. With this quilt, I thought red very appropriate.

*Cutting Instructions:*

Red center - cut six  $2" \times 2"$

Dark 1 - cut one  $1\frac{1}{2}" \times 13"$



Dark 2 - cut one  $1\frac{1}{2}" \times 19"$   
 Light 1 - cut one  $1\frac{1}{2}" \times 19"$   
 Light 2 - cut one  $1\frac{1}{2}" \times 25"$   
 Dark 3 - cut one  $1\frac{1}{2}" \times 25"$   
 Dark 4 - cut one  $1\frac{1}{2}" \times 31"$   
 Light 3 - cut one  $1\frac{1}{2}" \times 31"$   
 Light 4 - cut one  $1\frac{1}{2}" \times 37"$   
 Background sashing, cut five strips  $1\frac{3}{4}" \times 6"$ , two  $3\frac{1}{8}" \times 6"$ , and create two strips  $1\frac{3}{4}" \times 45"$

*Sewing Instructions:*

Assembly line sew each red center onto dark #1, press open and trim to fit. With dark #1 at the top assembly line sew to dark #2, press open and trim to fit. Repeat with each remaining light and dark strips. Remember always sew with piece just added at the top. Layout log cabin blocks all with light on one side. Place  $1\frac{3}{4}" \times 6"$  sashing strips in between each block and sew row together. Add  $3\frac{1}{8}" \times 6"$  to ends and press. Sew top and bottom  $1\frac{3}{4}" \times 45"$  strips to top and bottom of row. Press.

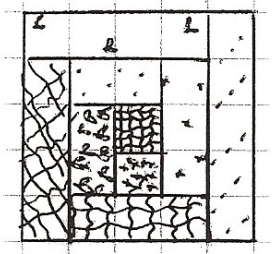

### #6 Applique Hearts

*Cutting Instructions:*

Background, cut two  $9\frac{1}{2}" \times 12"$

*Sewing Instructions:*

Trace four hearts (pattern in the back) onto fusible

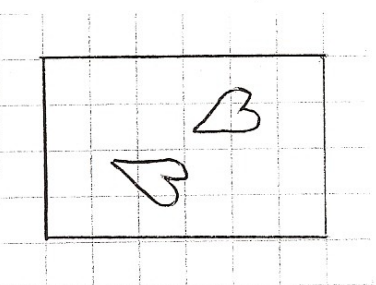

interfacing. Cut out, leaving  $1\frac{1}{4}$ " around heart. Place bumpy side of interfacing to right side of fabric. Sew on the traced line. Cut out leaving  $3\frac{1}{16}$ " to a  $1\frac{1}{4}$ " around heart. Clip curves. Gently pull interfacing away from heart fabric and clip an "X" in interfacing. Turn heart through "X". Smooth heart with fingers. Do not press. Place two hearts onto background fabrics, press into place. Machine or hand stitch to secure.

## #7 Family

**Dad:**

*Head* - Cut a  $2\frac{3}{4}$ " x 3" flesh fabric, sew a  $1\frac{1}{4}$ " x 3" brown hair fabric on top of face. Cut four 1" background squares and sew diagonally on each corner of head. Trim  $1\frac{1}{4}$ " from seam and press back.

*Neck* - Sew a  $1$ " x  $1\frac{1}{4}$ " flesh fabric in between two background  $1$ " x  $1\frac{3}{8}$ " pieces. Press and sew onto bottom of head. Press.

*Shirt* - Cut a  $3$ " x  $3\frac{1}{2}$ " shirt fabric and sew  $1$ " background squares onto shoulders. Sew onto head section. Press.

*Pants* - Cut a  $2$ " x  $3$ " pant fabric and two  $1\frac{1}{2}$ " x  $3$ " pant fabric for legs. Sew  $1$ " x  $3$ " background fabric between leg fabrics. Press. Sew to bottom of  $2$ " x  $3$ " pant fabric. Press. Sew pants onto shirt. Press.

*Arms* - (Shirt fabric can be substituted for flesh fabric to create shirt sleeves.) Create half square



triangles as described in Heart section for the leaves using a  $2\frac{1}{4}$ " x  $4\frac{1}{2}$ " background and flesh fabric. Square up with triangle square up ruler on the  $1\frac{3}{4}$ " line. Cut four  $3\frac{1}{4}$ " background squares and sew a square diagonally on flesh corner of half square triangles. Sew arms together. Cut four  $1\frac{3}{4}$ " x  $4\frac{1}{2}$ " background rectangles. Sew one on top and one to bottom of arms. Sew an arm on each side of dad, press.

*Shoes* - Cut two black shoes  $1\frac{1}{2}$ " x  $2$ ". Sew a  $1$ " x  $1\frac{1}{2}$ " background in between shoes. Cut two  $1\frac{1}{4}$ " x  $1\frac{1}{2}$ " background fabric, sew one on each side of shoe section, press. Sew onto bottom of dad. Press.

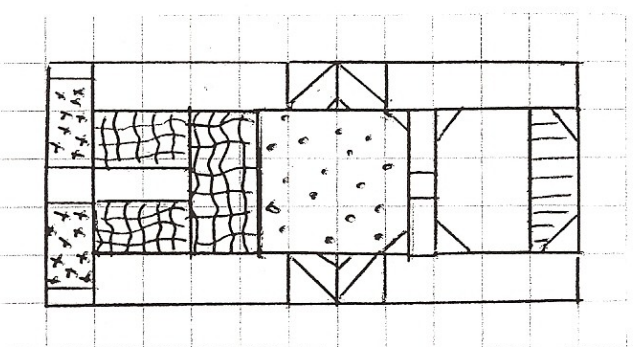

together. Cut two 1 1/4" x 1 1/2" background pieces and sew one onto top of each arm. Cut two 1 1/2" x 2 1/4" background pieces and sew one onto the bottom of each arm. Press. Sew arms to dress and press. Legs - Cut two 2" x 2 1/2", one 1" x 2 1/2" background, cut two 1 1/4" x 2 1/2" flesh for legs. Sew the 1" x 2 1/2" background in between the legs and the 2" x 2 1/2" backgrounds on outside of legs. Press. Sew to bottom of dress. Press

A hand-drawn floor plan of a rectangular room. The room is divided into a grid of sections. On the left wall, there are two windows, each represented by a grid pattern. In the center of the room is a circular area containing eight chairs, each represented by a small circle with a cross. The right wall features a doorway. The entire drawing is done in black ink on a grid background.



### Boy:

*Head* - Cut a  $2\frac{1}{4}" \times 2\frac{1}{2}"$  flesh for head, cut a  $1\frac{1}{4}" \times 2\frac{1}{2}"$  hat fabric and sew onto top of face. Cut four  $1"$  background squares and sew diagonally on each corner of face and hat. Trim  $1\frac{1}{4}"$  past stitching line, press back. Cut a  $1\frac{3}{4}" \times 3"$  background and sew to left side of head. Cut a  $\frac{3}{4}" \times 1\frac{1}{4}"$  hat fabric for brim, sew a  $1" \times 1\frac{1}{4}"$  background to top of hat brim and a  $1\frac{1}{4}" \times 2\frac{1}{4}"$  on bottom of hat brim. Press. Sew onto right side of head. Cut a  $1" \times 3"$  background and sew on right side. Press. Sew a  $4" \times 5"$  background onto top of head and press.

*Neck* - Cut a  $1" \times 1"$  flesh and sew between two  $1" \times 2\frac{1}{2}"$  background strips. Press and sew onto head.

*Shirt* - Cut a  $2\frac{1}{2}" \times 3"$  shirt print.

*Arms* - Create two half square triangles, as directed in heart row for leaves, using a  $2" \times 4"$  rectangle of background and flesh fabric. Square up on the  $1\frac{1}{2}"$  line on triangle square up ruler. Press open. Cut four  $\frac{3}{4}"$  squares of background. Sew these diagonally onto flesh corner of half square triangles. Trim and press back. Sew half square triangles together to form arms. Sew onto side of shirt. Press and sew onto neck. Press.

*Legs* - Cut two  $1\frac{1}{2}" \times 3"$  pant fabric and sew a  $1" \times 3"$  background in between legs. Cut two  $1\frac{1}{2}" \times 3"$  background and sew one on each side of leg. Press. Sew onto shirt.

*Shoes* - Cut two  $1" \times 1\frac{3}{4}"$  black and sew a  $1" \times 1"$

background in between shoes. Cut two  $1" \times 1\frac{1}{4}"$  background and sew one on each side of shoes. Press. Sew onto pants. Press.

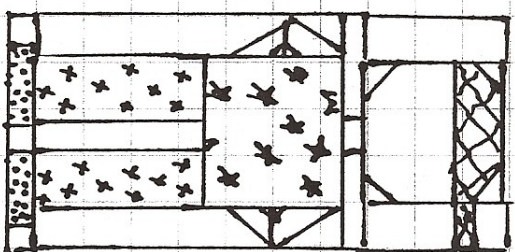

### Girl:

*Head* - Cut a  $2\frac{1}{4}" \times 2\frac{1}{2}"$  flesh fabric for face. Cut a  $1\frac{1}{4}" \times 2\frac{1}{2}"$  brown hair and sew on top of face.

Cut four  $1"$  background squares and sew two diagonally onto corners of hair and two onto corners of face. Trim and press back. For pigtails create half square triangles as directed in heart row for leaves, using a  $2" \times 4"$  background and hair fabric. Square up on triangle square up ruler using the  $1\frac{1}{2}"$  line. Press. Cut four  $1\frac{1}{4}" \times 2\frac{1}{2}"$  background pieces and sew one on top and bottom of each pigtail. Press. Sew onto sides of head. Press. Cut a  $4" \times 6\frac{1}{2}"$  background fabric and sew on top of head. Press.

*Neck* - Cut a  $1" \times 1"$  flesh fabric and two  $1" \times 3\frac{1}{4}"$



backgrounds. Sew neck in between backgrounds. Press. Sew onto head.

*Dress and Arms* - Cut a 3" x 3" and a 1" x 4" from dress fabric. Create half square triangles for arms by following instructions from heart row for leaves, using 2" x 4" background and flesh fabric. Square up on ruler using the 1½" line. Press open. Cut four ¾" background squares and sew diagonally onto flesh corner of half square triangles. Trim and press back. Sew arms together. Cut two 1" x 1½"

backgrounds and sew one onto bottom of each arm section. Press and sew onto dress. For bottom of dress, use the previously cut 1" x 4" dress fabric and cut two 1" x 1½" background pieces. Position one background piece onto dress fabric as in diagram. Sew a diagonal line across fabrics. Trim excess seam allowance and press back. Repeat on other end of skirt. Cut two 1 1/4" x 3 ½" background rectangles and sew one onto each side of body and arm section. Press and sew onto neck.

*Legs* - Cut two 1" x 2" flesh fabric, cut a 1" x 2" background and sew in between legs. Cut two 2" x 2 ¾" background and sew one on each side of legs. Press and sew to bottom of dress.

*Shoes* - Cut two 1" x 1½" black shoes, cut a 1" x 1" background and sew in between shoes. Cut two 1" x 2 1/4" background and sew one onto each side of shoe. Press and sew onto legs.

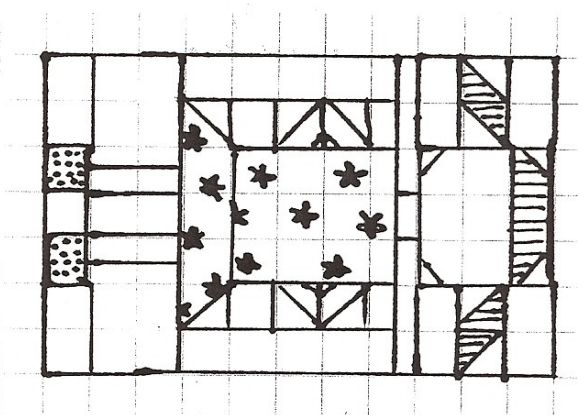

#### Pet:

Cut a 2 ¾" x 3" pet fabric for body and two 1 1/4" x 1½" for legs. Cut a 1½" x 1½" background fabric and sew in between pet legs. Press and sew to bottom of body. Cut a 1½" x 1½" pet fabric for head, cut a 1½" x 2 ¾" background fabric onto bottom of head. Press and sew onto left side of body. Press. Cut a 1" x 1" pet fabric. Fold the 1" pet fabric in half diagonally and finger press. Position this half diagonally again and finger press. Position this piece over head, it is your ear. Stitch in place. Cut a 1" x 4" background fabric and sew on top of head and body. Press. Cut a 1" x 1" pet fabric and two ½" background squares. Sew one background square diagonally onto corner of 1" pet fabric. Press back and repeat on opposite corner. This is the tail. Sew tail onto a 1" x 3 ¾" background fabric and sew onto right side of pet. Press. Cut a 4 ½" x 8 1/4"



background fabric and sew onto top of pet. Press. Cut a  $1\frac{3}{4}$ " x 12" background strip and sew onto left side of pet section.

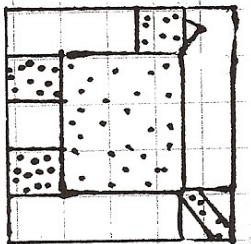

Sew the family together (refer to picture). Sew an applique heart onto each end of family row.

## #8 Nine Patches

### Cutting Instructions:

From background fabric cut the following, two  $3\frac{1}{2}$ " x 7", two  $4\frac{1}{4}$ " x  $4\frac{1}{4}$ ", five  $5\frac{1}{2}$ " x  $5\frac{1}{2}$ ", create two strips  $1\frac{1}{2}$ " x 45".

From prints for nine patches cut nine different strips  $2$ " x  $12\frac{1}{2}$ " long.

### Sewing Instructions:

Create 6 nine patches by sewing strips in sets of three. Press one strip set toward the center, and two strip sets away from center. Cut these strips into 6 two inch segments. Using one segment from each strip set create 6 nine patches. The segment which is pressed towards the center is center of nine patch. This allows your seams to snuggle nicely. Press. Nine patches should measure 5". Cut  $5\frac{1}{2}$ " background fabric in half diagonally. Sew one on top



an bottom of nine patch as in diagram. Sew rows together. Cut  $4\frac{1}{4}$ " background square in half diagonally and sew on ends of rows. Press. Trim to 7" high. Sew  $3\frac{1}{2}$ " x 7" onto ends. Press. Sew  $1\frac{1}{2}$ " x 45" to top and bottom of nine patch row. Press.

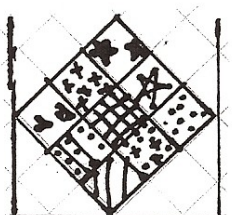
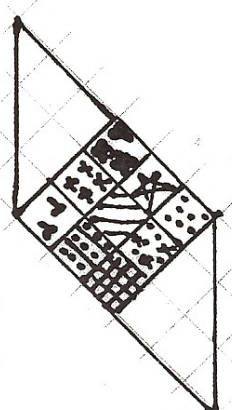

## #9 Pinwheels

### Cutting Instructions:

Background fabric, cut six  $4$ " x  $8$ " rectangles, five  $1\frac{1}{2}$ " x  $6\frac{1}{2}$ ", two  $2\frac{1}{2}$ " x  $6\frac{1}{2}$ ", create two strips  $1\frac{3}{4}$ " x 45"

Pinwheels, six different prints cut one  $4$ " x  $8$ " rectangle from each

### Sewing Instructions:

Create half square triangles as instructed in heart row for the leaves, using the  $4$ " x  $8$ " rectangles. Square up on triangle square up ruler using the  $3\frac{1}{2}$ " line. Press open. Assemble half square triangles to form pinwheels. Refer to diagram.

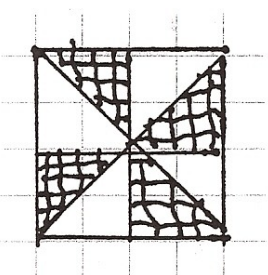

Make a total of six pinwheels. Sew a  $1\frac{1}{2}$ " x  $6\frac{1}{2}$ " background strip in between each pinwheel. Press. Sew a  $2\frac{1}{2}$ " x  $6\frac{1}{2}$ " background onto each end of pinwheel row. Press. Sew the  $1\frac{3}{4}$ " x 45" strips to top and bottom of row. Press.

### Assembling Quilt:

Sew embroidery to bottom of stars, press. Sew a house block to each side of star and embroidery section, press. Sew the remaining rows as follows. Heart row, log cabin row, family row, nine patch row, pinwheel row.

### Borders:

Sew red  $2\frac{1}{2}$ " strip to the sides and red 2" strip to top and bottom. Using "Quilt In a Day" large flying geese ruler, create 60 flying geese. (Using the ruler, you will be creating four geese at a time.) Sew two rows of twelve flying geese each for top and bottom border. Sew two rows with seventeen geese for sides. (You will have two geese left over.) Cut corner squares  $8\frac{1}{2}$ " x  $8\frac{1}{2}$ ". You may choose to applique hearts or embroider family quotes in these corners. Be creative.



I would like to share one of my family's most requested recipes. My mom and grandma used to make it. Hope you enjoy this quilt and the sweet rewards of life!

### APPLE PUDDING CAKE WITH CARAMEL SAUCE

2 Cups sugar	1 Cup shortening
2 eggs	1 tsp. cinnamon
1 tsp. salt	1 tsp. nutmeg
2 Cups flour	1 tsp. soda
1 Cup chopped nuts	8 med. peeled and grated apples

Cream together the sugar, shortening and eggs. Add remaining ingredients and stir well. Bake in a greased 9" x 13" cake pan, at 350° for 45 minutes.

### CARAMEL SAUCE

2 Cups brown sugar  
 $\frac{1}{2}$  Cup butter  
1 tsp. vanilla  
1 can sweetened condensed milk  
1 Cup corn syrup

Mix sugar, syrup, and butter until melted. Add sweetened condensed milk. Bring to a boil and remove from heat. Add vanilla and serve over cake with a scoop of ice cream.



# Love Is Spoken Here - approximately 64" x 84"

## Supply List:

Quilt In A Day 6  $\frac{1}{2}$  inch triangle square up ruler

Quilt In A Day large flying geese ruler

3/8 yd. each of 3 different backgrounds - stars, log cabins, flying geese border

3/8 yd. each of 6 different prints - stars, log cabins, houses, family, pinwheels, nine patches, small hearts, flying geese border

1/3 yd. - heart background

1/3 yd. - family background

5/8 yd. - embroidery and pinwheel background, flying geese border

5/8 yd. - nine patch and house background

$\frac{1}{4}$  yd. - log cabin sashing

1/3 yd. - one large heart, log cabin, flying geese border

$\frac{1}{2}$  yd. - border embroidery, one large heart, pinwheel, log cabin, house, family, flying geese border

$\frac{1}{2}$  yd. - one large heart, stars, log cabins, houses, family, nine patches, pinwheel, flying geese border

$\frac{1}{2}$  yd. - corners on border, flying geese border, appliqué background

1/8 yd. flesh

1/8 yd. or scraps for hair

1/8 yd. or scraps for shoes

1  $\frac{1}{4}$  yd. first border and binding

5 yards backing

All rights reserved. No part of this pattern may be reproduced by any means without written consent from Rebecca Morganson. All items from this pattern are protected by copy-right laws and may not be used for commercial purposes without written permission.

## Stitches and Sew Forth

51 South Historic Main Street

Payson, Utah 84651

801-465-9133

Visit us at [www.stitchesandsewforth.com](http://www.stitchesandsewforth.com)

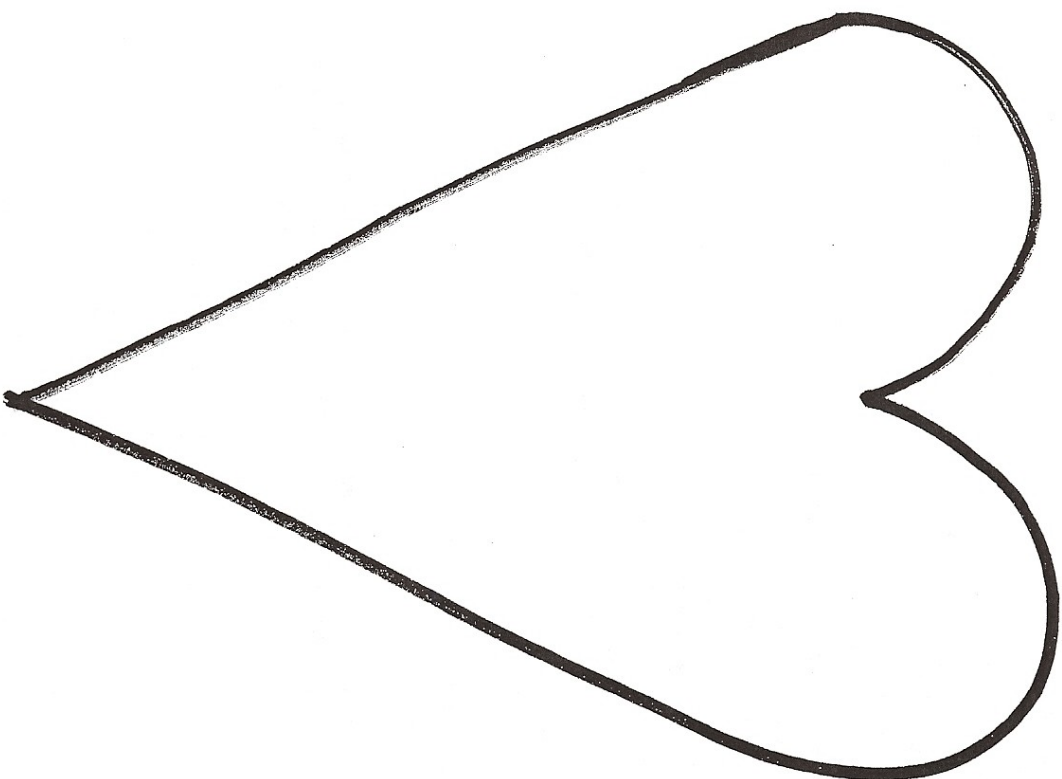

NOV 15

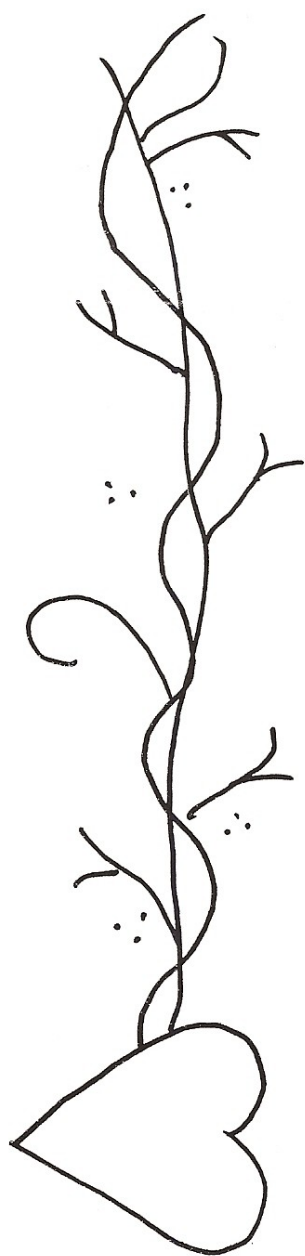

Spoken here

